

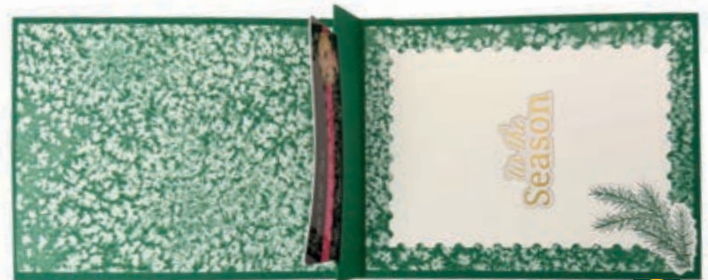

Elegant Pine Snowflakes Gift Card Holder

CUTS

- **Shaded Spruce Card Base:** 11" x 4-1/4"
◦ Score at 5-1/2"
- **Shaded Spruce Insert:** 4-1/4" x 3"
◦ Score Short Side at 1/2", 1-1/2" & 2-1/2"
- **Cherry Cobbler:** 5-3/8" x 4-1/8"
- **Designer Paper:** (3) 5-1/4" x 4
- **White Inside:** 4-1/2" x 3-1/4" or die cut with Perennial Postage die.



7

INSTRUCTIONS

On Basic White Cardstock scrap stamp:

- 5 Pinecones in Espresso Ink. **1**
- The snowflake shown in Shaded Spruce Ink. **2**
- A Pine Bough in Spruce Ink for the inside. **7**
- 2 Leaves in Vellum (not shown).

Using the Stampin' Cut & Emboss Machine:

- Cut out the pinecones, pine bough and snowflakes.
- Die cut a large Snowflake from the Designer Paper. **3**
- Several die cut fir branches in Spruce. **4**
- 2 Large Snowflakes in Spruce and Cut in half. **5**
- Small Snowflake in Gold Foil. **6**
- Cut the Perennial Postage rectangle for the inside.



Elegant Pine Snowflakes Gift Card Holder

Tami White
tami@stampwithtami.com
www.stampwithtami.com



Assemble the Snowflake:

- Attach the 4 Shaded Spruce large snowflake halves to the back of the designer paper snowflake to create a thin border. As shown in 1 & 2.
- Attach a the stamped smaller snowflake to the larger panel with Stampin' Dimensionals. The attach a red snowflake gem to the small gold snowflake and attach on top. As shown in 3.
- Using Mini Glue Dots or Seal Adhesive attach the Pinecones to the front, and the Shaded Spruce and Vellum foliage to the back. As shown in 4.



Complete Front Assembly

- Attach 2 pieces of ribbon across the top and sides of front designer paper layer with Seal Adhesive.
- Attach the designer paper layer and Cherry Cobbler frame to the card base front with Seal Adhesive.
- Attach the Snowflake panel with Stampin' Dimensionals.
- Attach the 2 greetings from the Greetings for You Ephemera Pack.

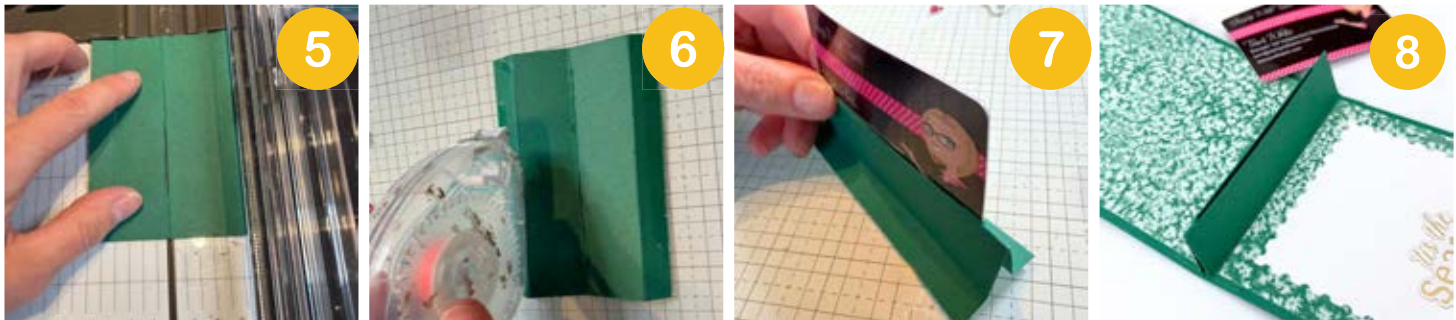

Create the Gift Card Holder Pop Up

- Pop Up is 4-1/4" x 3" Scored on the short side at 1/2", 1-1/2" & 2-1/2"
- Using a trimmer or hobby knife, cut a slice in the center score line from 1/4" to 4". As shown in 5.
- Apply Seal Adhesive on either end. As shown in 6.
- Fold as shown in 7. You can insert the gift card before or after attaching to the card.
- Attach to the inside fold of the card base. Then attach designer paper on either side. As shown in 8.
- Attach the white layer and greetings to the inside.

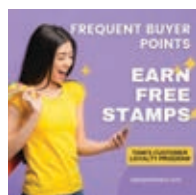

Elegant Pine Snowflakes Gift Card Holder

Tami White
tami@stampwithtami.com
www.stampwithtami.com



Elegant Pine Snowflakes Suite Collection - 166079



Delicate Pines Bundle (English) - 166074



Early Espresso Classic Stampin' Pad - 147114



Shaded Spruce Classic Stampin' Pad - 147088



Greetings For You Mix & Match Ephemera Pack - 166208



Elegant Pine Snowflakes 12" X 12" Designer Series Paper - [166066](#)



Gold Foil Sheets - 132622

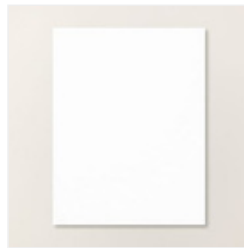

Basic White 8-1/2" X 11" Cardstock - 166780



Cherry Cobbler 8-1/2" X 11" Cardstock - 119685



Shaded Spruce 8-1/2" X 11" Cardstock - 146981

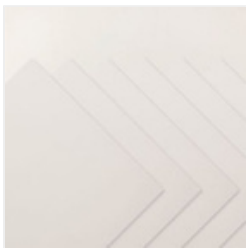

Vellum 12" X 12" (30.5 X 30.5 Cm) Specialty Paper - 167099



Perennial Postage Dies - 162607



Shaded Spruce & Gold Edged 7/8" (2.2 Cm) Ribbon - 166078

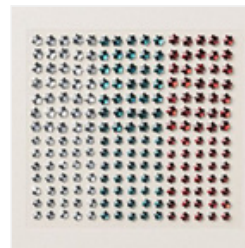

Faceted Snowflakes - 166077



Paper Trimmer - 152392



Stampin' Cut & Emboss Machine - 149653



Stampin' Seal - 152813



Stampin' Dimensionals - 104430