



FLORAL DELIGHT CIRCLE WREATH CARD



SEE VIDEO TUTORIAL FOR HELP WITH THE FOLD

CUTS

- Basic White Cardbase: 5-1/4" x 5-1/4" score in half at 2-5/8"
- Crumb Cake Designer Series Paper: 5-1/4" x 5-1/4" score in half at 2-5/8"

INSTRUCTIONS

- Attach the Crumb Cake designer paper to the Basic White card base.
 - See video for help with creating the card base.
- Using the Stampin Cut & Emboss Machine:
 - Cut a circle from the center of the card base with the Around It All Dies.
 - Cut a circle frame for the flowers using 2 different sized circles.
 - Cut the word "wishing" from Gold Foil & Mossy Meadow.
 - Cut the label die for the words from Mossy Meadow & Branches from Early Espresso.
- Hand cut the flowers from the Floral Delight Designer Series Paper.
- Stamp and Heat emboss the words on the die cut label.
- Assemble the card with Seal Adhesive and Stampin' Dimensionals.
- Attach Tiny Bee Trinkets.

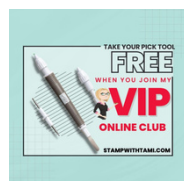
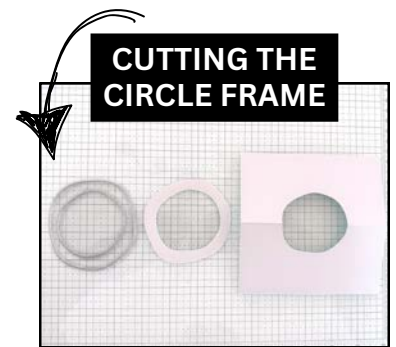

Floral Delight Circle Wreath Card

Tami White
tami@stampwithtami.com
www.stampwithtami.com



FLORAL DELIGHT SUITE

- DELIGHTFUL WISHES STAMP SET
- DELIGHTFUL WISHES DIES
- FLORAL DELIGHT 12" X 12" DESIGNER SERIES PAPER
- FLORAL & GINGHAM VELLUM 12" X 12" SPECIALTY DESIGNER SERIES PAPER
- DAFFODIL DELIGHT 1/8" SATIN RIBBON
- TINY BEE TRINKETS

2025
Jan-Apr
Mini

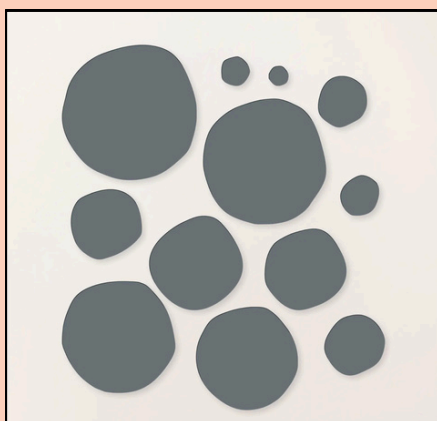

AROUND IT ALL DIES

Item #164725

January 2025
Online
Exclusives



Gold Foil Sheets -
132622



Basic White 8-1/2"
X 11" Cardstock -
159276



Mossy Meadow 8-
1/2" X 11"
Cardstock -
133676



Early Espresso 8-
1/2" X 11"
Cardstock -
119686



VersaMark Pad -
102283



Heat Tool - 129053



Metallics Wow!
Embossing
Powder - 165678



Paper Trimmer -
152392



Stampin' Cut &
Emboss Machine -
149653



Stampin' Seal -
152813



Adhesive Sheets -
152334

