



This American Flag card is part of my Americana set. Be sure to visit my Hey Sports Fan Series for instructions for the rest.

- Card Base: 8-1/2" x 5-1/2"
Scored at 4-1/4"
- Night of Navy: 5-1/2" x 4-1/4" (or largest stitched rectangle)
- Designer Series Paper (Stripes): 5" x 3-3/4" (or 2nd largest rectangle)
- Very Vanilla (Inside): 5-1/4" x 4"
- Blue DSP: 2-1/4" x 1-3/4" (or stitched rectangle die)
- Scraps of Very Vanilla for stars

CARD INSTRUCTIONS:

- Attach the Adhesive Sheet to the back of Very Vanilla scrap and cut out the stars die from the Sports Event die.
- Attach the stars to the blue DSP panel.
- Assemble the card with Seal Adhesive. Use Stampin' Dimensionals to attach the Night of Navy panel.

American Flag Card

Tami White
tami@stampwithtami.com
www.stampwithtami.com



Hey Sports Fan-Suite Collection (English) - 157896

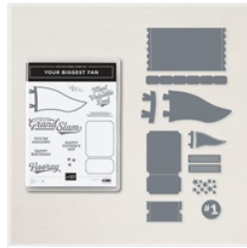

Your Biggest Fan Bundle (English) - 157893



Hey Sports Fan 12" X 12" (30.5 X 30.5 Cm) Designer Series Paper - 157882



Very Vanilla 8-1/2" X 11" Cardstock - 101650



Night Of Navy 8-1/2" X 11" Cardstock - 100867



Real Red 8-1/2" X 11" Cardstock - 102482

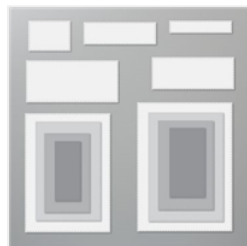

Rectangle Stitched Dies - 151820



Stampin' Cut & Emboss Machine - 149653



Stampin' Seal - 152813



Adhesive Sheets - 152334



Stampin' Dimensionals - 104430



COLLECT THEM ALL AT
STAMPWITHTAMI.COM